

CURRENT GENERAL PLAN LAND USE DESIGNATIONS

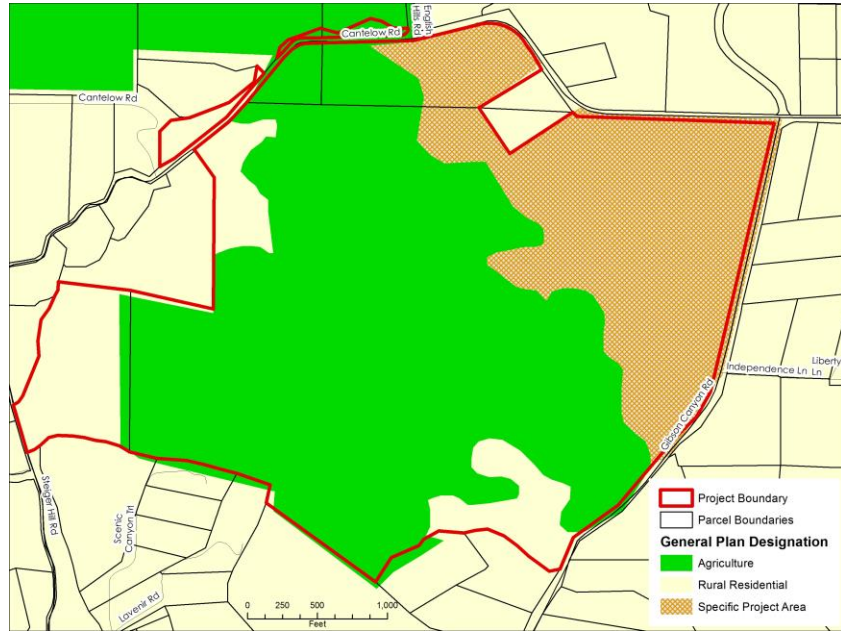

PROPOSED GENERAL PLAN LAND USE DESIGNATIONS

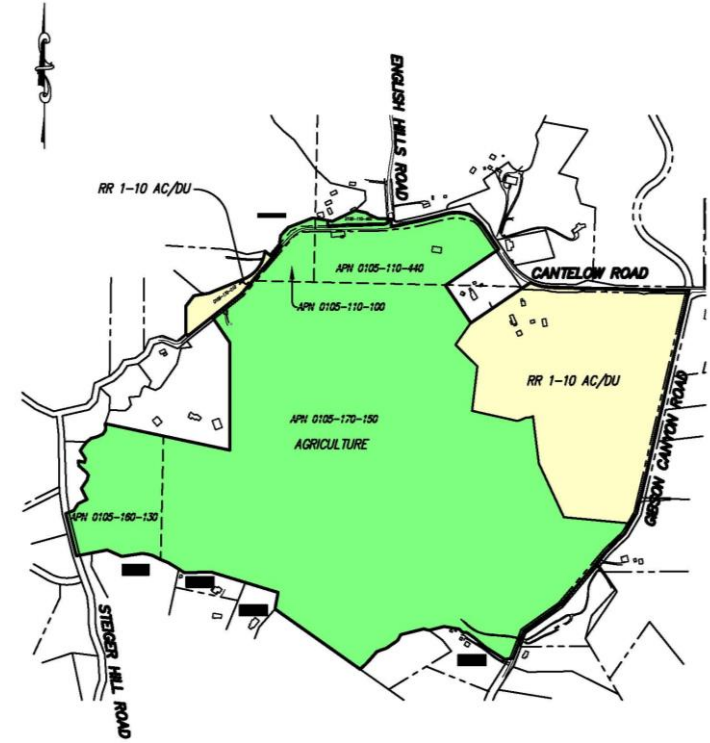

Current GP Land Use Designation	Acres	Proposed Land Use Designation	Acres
Specific Project Area	65.8	Rural Residential	64.1
Specific Project Area	22.73	Agriculture	24.43
	88.53		88.53
Rural Residential	18.2	Agriculture	18.2
Rural Residential	2.9	Rural Residential	2.9
Agriculture	200.87	Agriculture	200.87
	310.5		310.5
		Total Proposed	
		Rural Residential	67
		Agriculture	243.5
			310.5

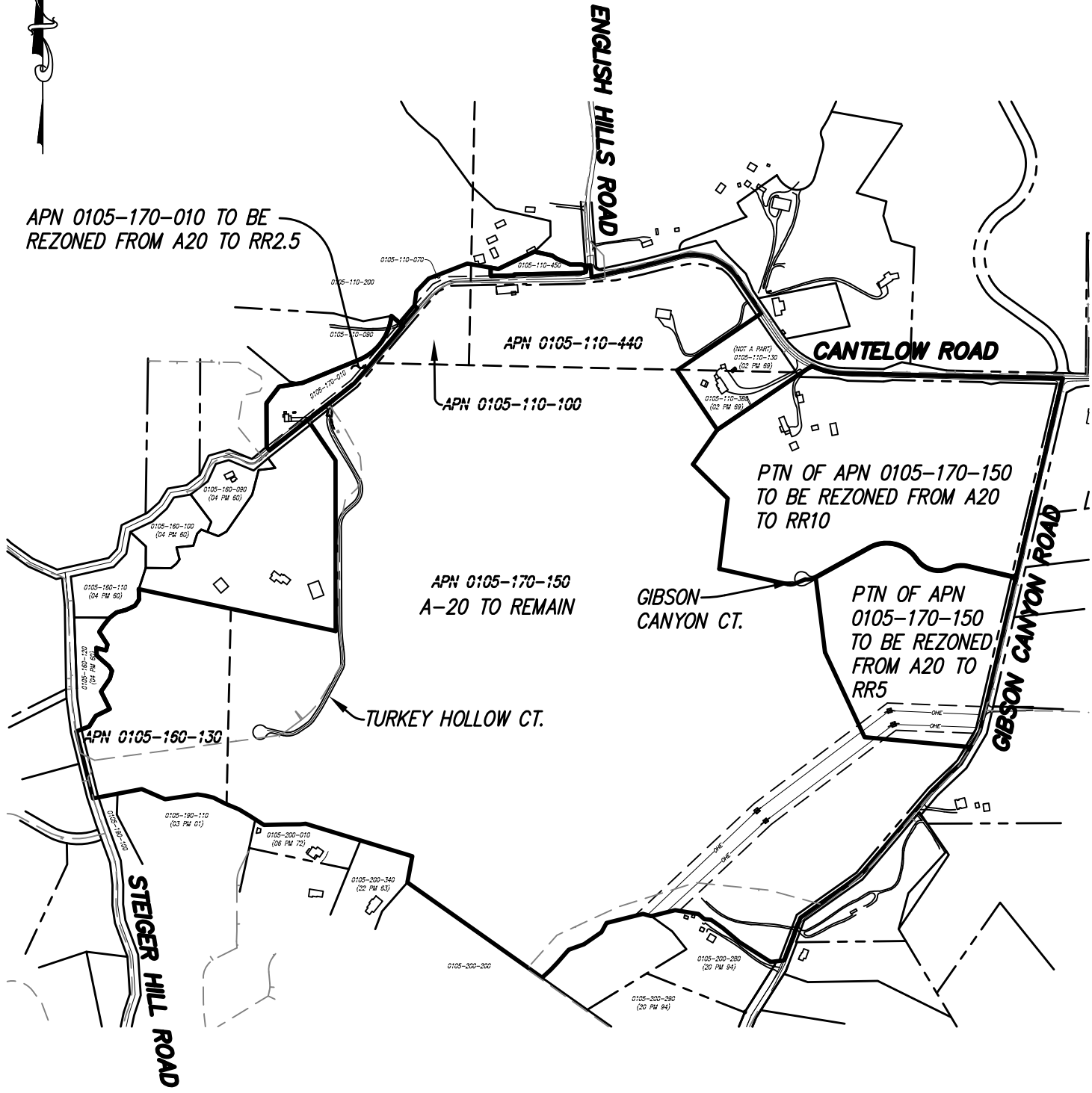

APN 0105-170-010 TO BE REZONED FROM A20 TO RR2.5

APN 0105-110-440

APN 0105-110-100

APN 0105-170-150
A-20 TO REMAIN

PTN OF APN 0105-170-150
TO BE REZONED FROM A20
TO RR10

PTN OF APN
0105-170-150
TO BE REZONED
FROM A20 TO
RR5

APN 0105-160-130

TURKEY HOLLOW CT.

STEIGER HILL ROAD

ENGLISH HILLS ROAD

CANTELOW ROAD

GIBSON CANYON CT.

GIBSON CANYON ROAD

FCE

FOULK CIVIL ENGINEERING, INC.

Civil Engineering Land Surveying Planning

4777 Mangels Boulevard, Fairfield, CA 94534

(707)864-0784 fax (707)864-0793 e-mail: foulkce@gmail.com

REZONING EXHIBIT
LANDS OF MORGAN
SOLANO COUNTY

SCALE: 1"=800'

DATE: 12/18/19

DWG: 07-045

JOB NO: 07-045

DRAWN BY: AJH/NRF

CHECKED BY: BDF