

OPTION #1
WALL FILL-IN OF
GARAGE DOOR OPENING

USING A CIRCULAR SAW WITH A DIAMOND BLADE, CUT A SHALLOW GROOVE INTO THE SLAB PARALLEL TO THE WALL ABOUT 2 INCHES FROM THE WALL FRAMING. CLEAN OUT THE GROOVE AND APPLY A BEAD OF MASONRY CAULK. BED THE EDGE OF THE PRE-BENT PIECE OF FLASHING IN WET CAULK, THEN NAIL THE FLASHING TO THE WALL STUDS.

APPLY A SECOND BEAD OF CAULK ALONG THE CONCRETE-TO-FLASHING JOINT AND SEAL WHERE THE CORNERS OVERLAP. INSTALL SHEATHING AND/OR EXTERIOR WALL FINISH.

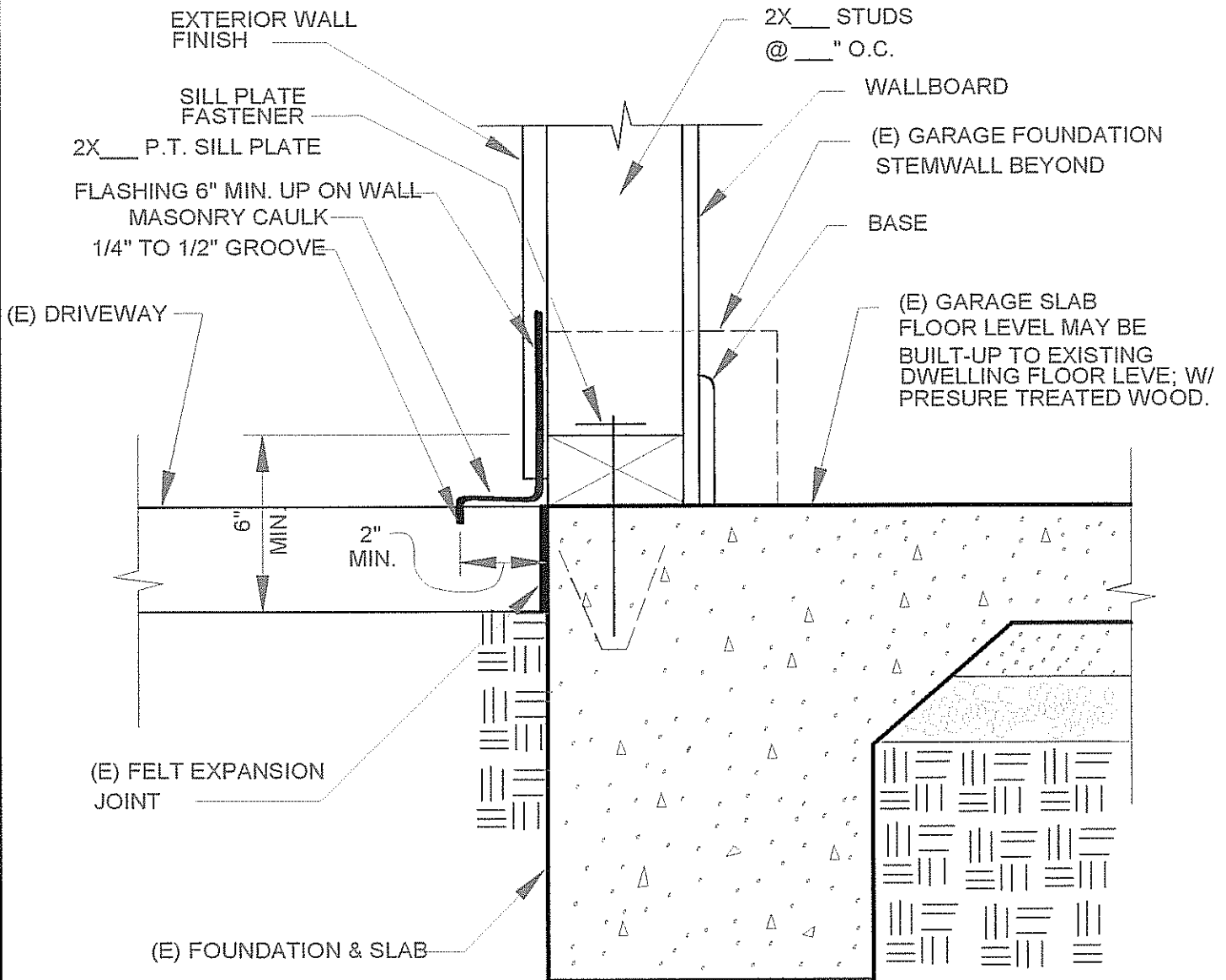

OPTION #2 WALL FILL-IN OF GARAGE DOOR OPENING